



PROVOST SKENE'S HOUSE

Getting around the building

Provost Skene's House dates from 1545. Due to the historic nature of the house we are sorry that the upper floors of the building are not accessible to wheelchair users or visitors with buggies. On the ground floor all visitors can explore the Hall of Heroes. In the Small Access gallery beyond the Hall of Heroes you can read a short history of the building, find out about previous occupants of the house, read about

all the people featured in the displays on the upper floors and vote for the next person to be added to the Hall of Heroes.

The upper floors are reached by winding stone staircases with lots of steps which visitors with restricted mobility may find difficult. Please watch out for low ceilings and uneven floors as you make your way round the building.

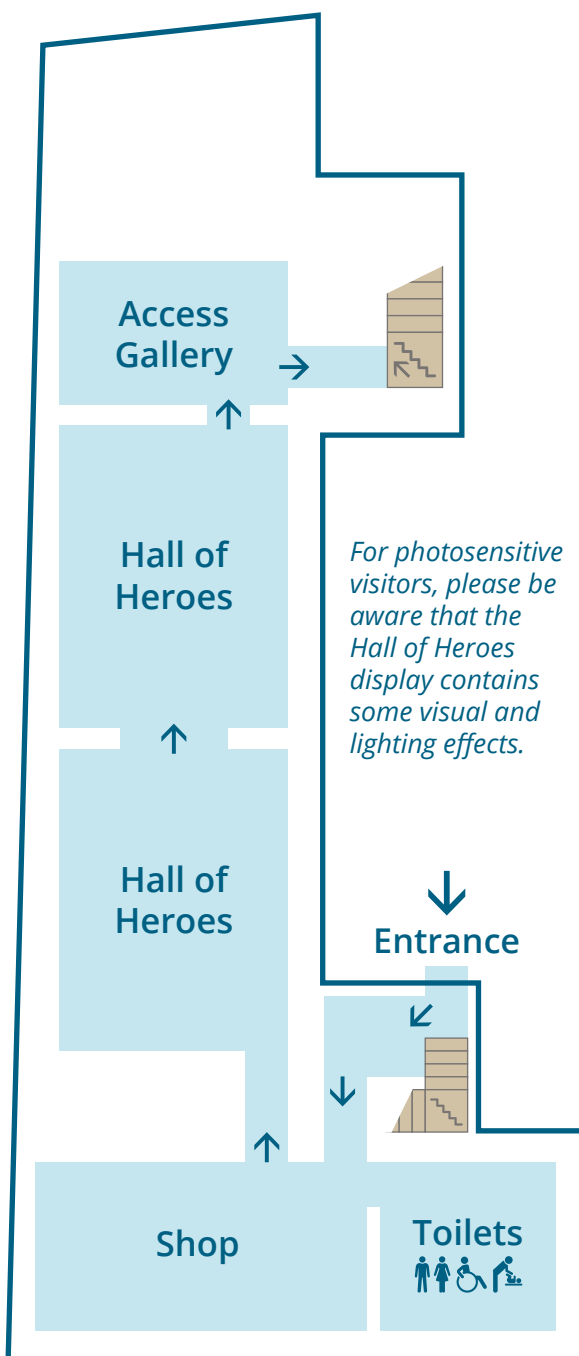

Ground floor

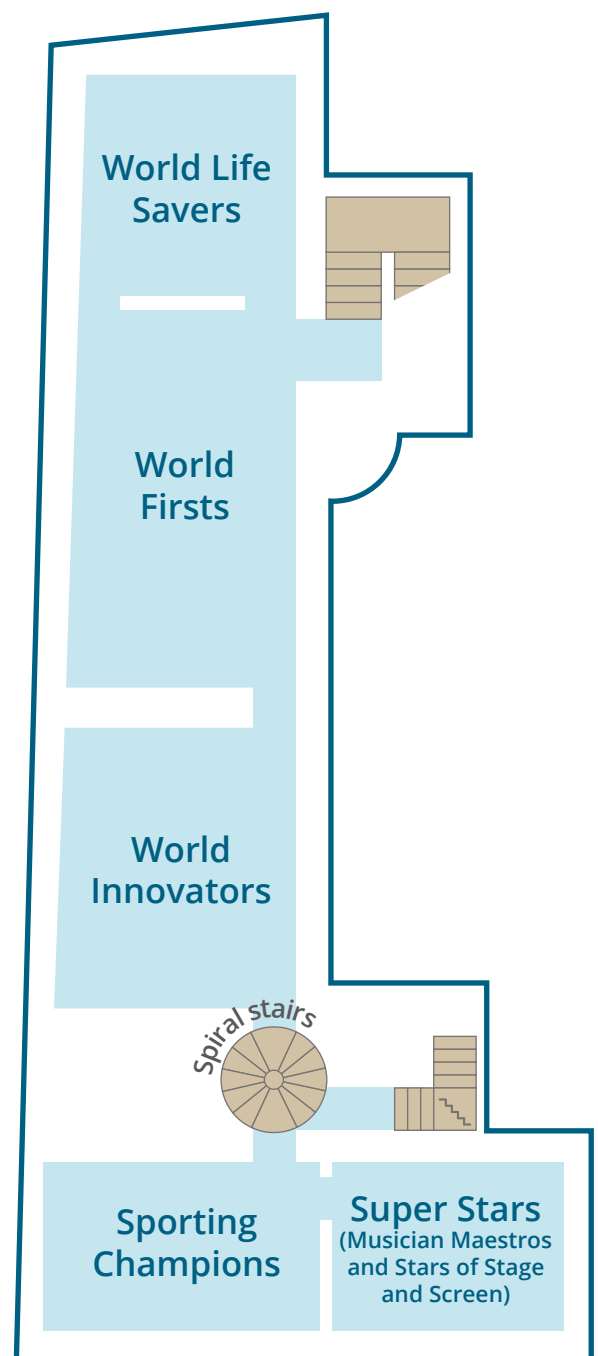

First floor



PROVOST SKENE'S HOUSE

Getting around the building

Visit the Provost Skene's House shop before you leave, where you're sure to find something beautiful (or fun!) to take home with you. Choose from gifts and souvenirs inspired by the themes explored in the house, from Wizard Wordsmiths and Natural Wonders to Scientific Saviours.

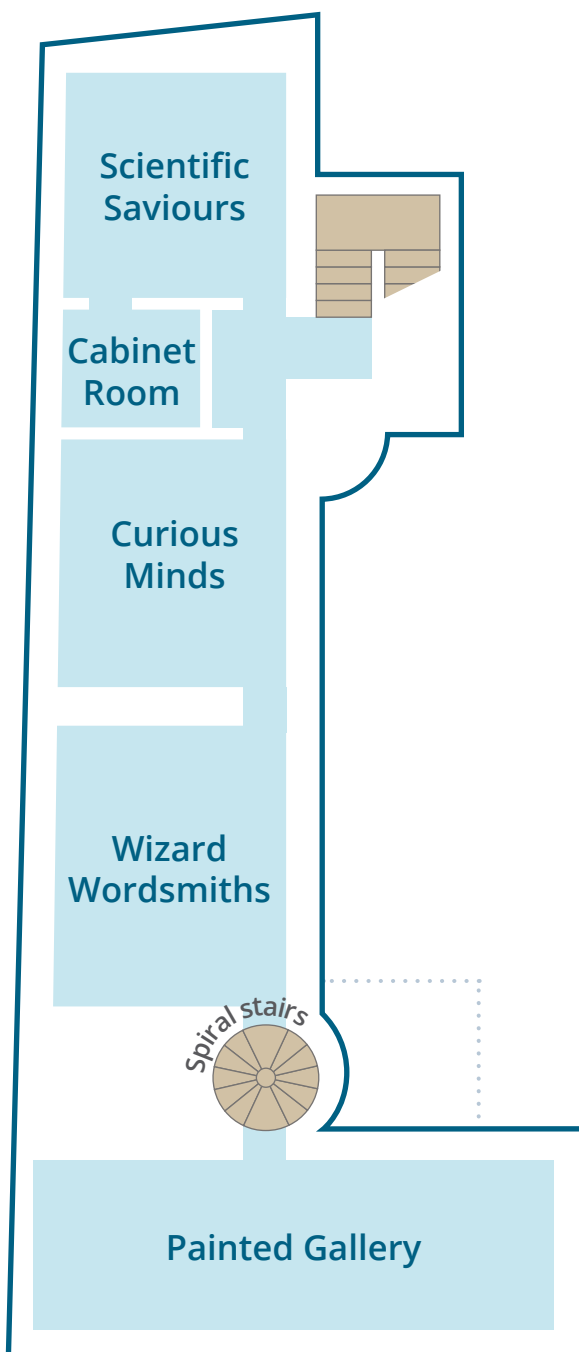

Second floor

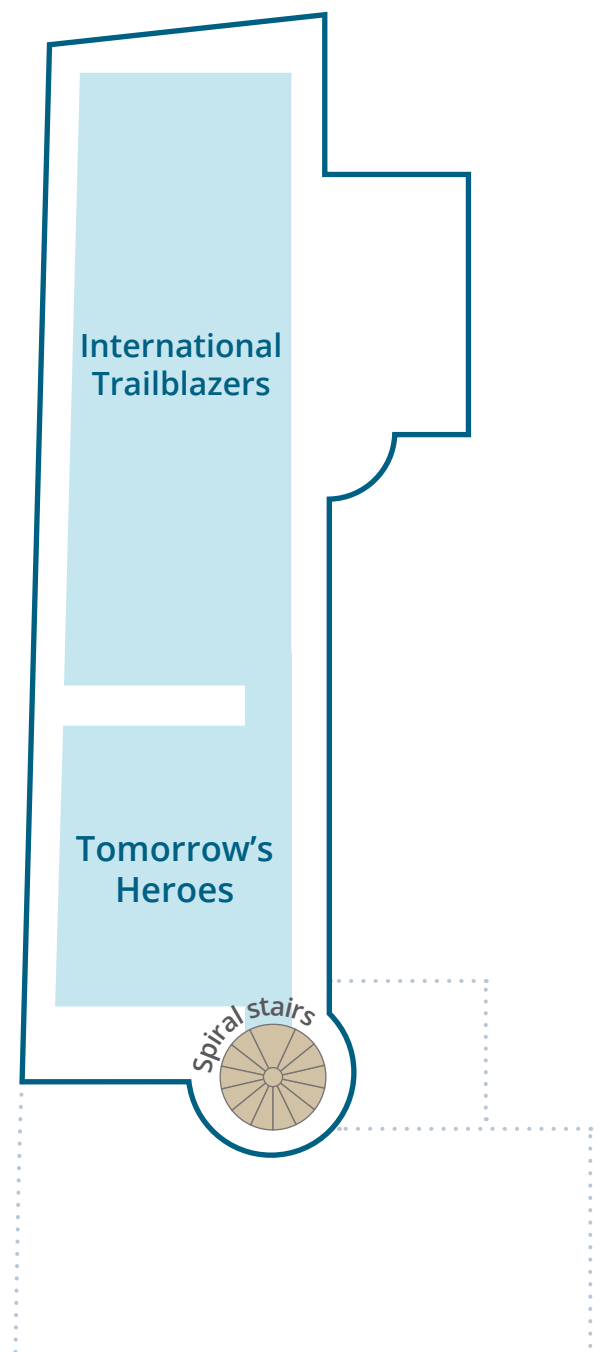

Third floor